

LINTEL TYPES

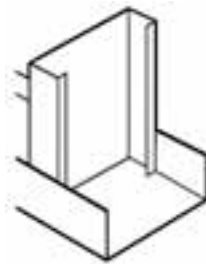

LT1
Shallow track Lintel.
Base configuration.
Suitable for small/medium sized openings.



LT2
Deep track Lintel.
Suitable for medium sized openings

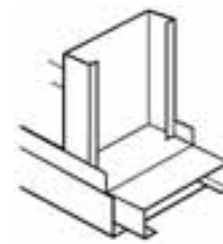

LT3
Deep track Lintel with stud and shallow track on back of stud.
Suitable for medium/large openings and /or medium/high wind load conditions.

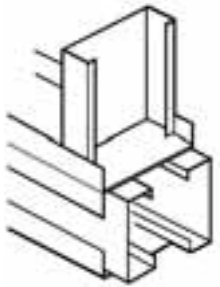

LT4
Shallow track Lintel with two stud sections inserted vertically and capped with a pair of back to back shallow track sections.
Heavy duty Lintel suitable for large openings and/or high wind load conditions.

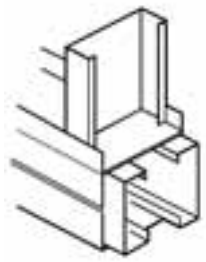

LT5
Deep track Lintel with two stud sections inserted vertically and capped with a pair of back to back deep track sections.
Extra Heavy duty Lintel suitable for large openings and/or high wind load conditions

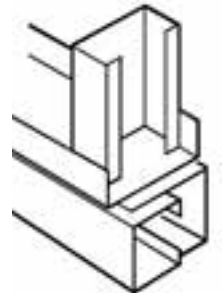

LT6
Heavy duty Lintel with deep track and stud to form a closed box.
Capped with shallow track section.
Suitable for large openings.

CILL TYPES



CT1
Shallow track Cill.
Basic Cill configuration.
Suitable for small/medium sized openings.



CT2
Deep track Cill.
Suitable for medium sized openings.

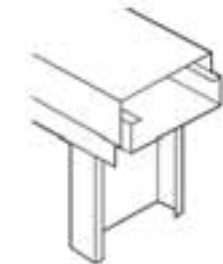

CT3
Shallow track over supporting studs with closed box of stud and deep track fitted on top.
Heavy duty Cill suitable for large openings or openings subjected to high wind load conditions.

JAMB TYPES

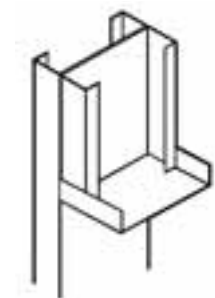

JT1
Basic Jamb configuration.
Suitable for small/medium openings.

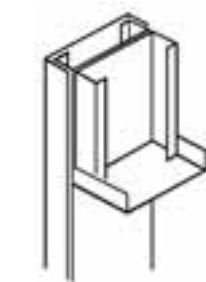

JT2
Single stud Jamb closed on reverse side with Shallow track section to form a box.
Suitable for medium sized openings.

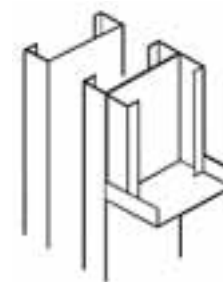

JT3
Single stud Jamb and brick tie stud.
Suitable for small/medium sized openings where external finish is masonry.

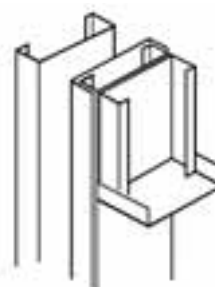

JT4
Single stud Jamb closed on reverse side with Shallow track section to form a box with brick tie.
Suitable for medium openings where external finish is masonry.

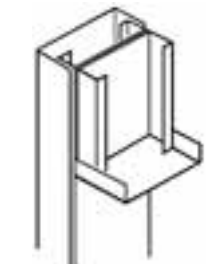

JT5
Single stud Jamb closed on reverse side with Deep track section to form a box.
Suitable for large openings and/or openings subjected to high wind load conditions.

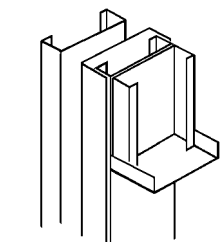

JT6
Single stud Jamb closed on reverse side with Deep track section to form a box with brick tie.
Suitable for large openings and/or openings subjected to high wind load conditions where external finish is masonry.